

No. of Pins	Dimension(mm)	
	L1	L2
002	5.08	7.62
003	10.16	12.70
004	15.24	17.78
005	20.32	22.86
006	25.40	27.94
007	30.48	33.02
008	35.56	38.10
009	40.64	43.18
010	45.72	48.26
011	50.80	53.34
012	55.88	58.42
013	60.96	63.50
014	66.04	68.58
015	71.12	73.66
016	76.20	78.74
017	81.28	83.82
018	86.36	88.90
019	91.44	93.98
020	96.52	99.06

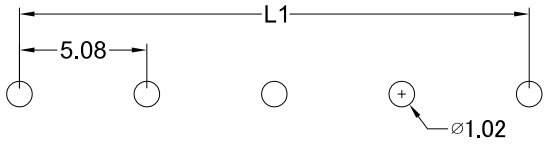
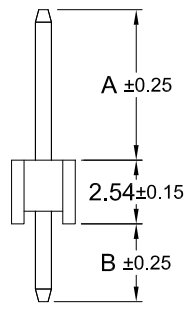
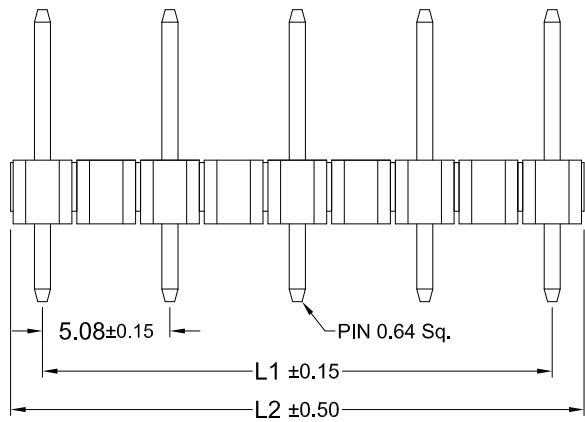
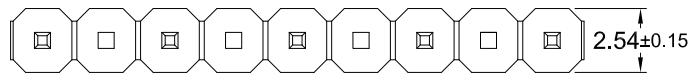

Recommended PCB Hole Layout
(PCB TOLERANCE ±0.05)

REV.	DESCRIPTION	DATE	DRAWN
A	NEW	24.06.2005	Linda
B	Add Pin Coed "140/14"	25.02.2013	Ryan
C	update pin coed	28.01.2016	Ryan

Order Code
SL1-xxx-S xxx/xx-xx/5

No. of Pin
002 to 020

Pin Type
See Table on sheet 2/2

Plating
55 = Gold flash (Standard)
66 = 10µ" Gold
77 = 15µ" Gold
88 = 30µ" Gold
99 = Tin
 Duplex plating
95 = Tin/Gold flash
96 = Tin/10µ" Gold
97 = Tin/15µ" Gold
98 = Tin/30µ" Gold

Execution

P.B.T Insulator (standard) = **S**
High Temp Insulator = **SH**

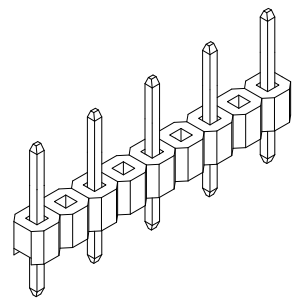

Materials

Insulator Material: PBT or High Temp Thermoplastic
 Color: Black, UL 94V-0
 Contact Material: Brass
 Plating: Gold, Tin or Duplex
 *Duplex = Tin on solder area, Gold plated on contact area
 Operating Temperature: -40° ~ +105°C

Specifications

Electrical

Current Rating: 3A
 Insulator resistance: 1000 MΩ min.
 Contact Resistance: 20 mΩ max.
 Dielectric Withstanding: AC 500V/Minute

E-tec 2015 © - all rights reserved



UNIT mm	GENERAL TOLERANCE		DRAWN Linda	DATE 24.06.2005	DWG. NO. SL1-Sxxx/xx/5	SHEET 1/2	
	X.° ±	X. ±					
	SCALE Free	.X° ±	.X ±	CHECK Kent	DATE 28.01.2016	SERIES NO. SL1-xxx-Sxxx/xx-xx/5	REV. C
		.XX° ±	.XX ± 0.25				
	.XXX° ±	.XXX ±	APPROVE SH	DATE 28.01.2016			

5.08mm Pitch Pin Header
 (2.54mm pitch insulator Void even pin)
 -THT- Straight

Pin-Code	Dim."A" (mm)	Dim."B" (mm)	Pin-Code	Dim."A" (mm)	Dim."B" (mm)	Pin-Code	Dim."A" (mm)	Dim."B" (mm)	Pin-Code	Dim."A" (mm)	Dim."B" (mm)	Pin-Code	Dim."A" (mm)	Dim."B" (mm)
076/03	2.00	3.10	140/10	5.70	5.80	167/01	7.10	7.10	155/08	10.00	3.00	198/02	14.00	3.30
069/01	2.20	2.20	184/12	5.70	10.20	112/01	7.16	1.50	180/08	10.00	5.50	198/01	14.30	3.00
060/01	2.50	1.00	209/03	5.70	12.70	125/13	7.20	2.80	190/05	10.00	6.50	204/01	14.90	3.00
079/01	2.70	2.70	216/01	5.70	13.40	128/03	7.30	3.00	209/04	10.20	8.20	219/01	14.90	4.50
085/01	2.70	3.30	240/01	5.70	15.75	115/02	7.50	1.50	184/03	10.50	5.11	200/03	15.00	2.54
083/01	2.90	2.90	267/01	5.70	18.50	125/02	7.50	2.54	163/02	10.70	3.10	210/05	15.46	3.00
085/02	3.00	3.00	106/02	5.80	2.30	126/03	7.50	2.60	184/07	10.70	5.11	216/08	16.00	3.10
088/01	3.00	3.30	108/01	5.80	2.50	136/07	7.50	3.60	155/06	10.80	2.20	245/03	16.00	6.00
186/03	3.20	12.90	113/02	5.80	3.00	175/02	7.50	7.50	159/06	10.80	2.54	216/06	17.11	1.95
257/01	3.20	20.00	116/07	5.80	3.30	123/02	7.60	2.20	165/01	10.80	3.20	228/01	17.30	3.00
091/01	3.30	3.30	185/03	5.80	10.20	134/01	7.70	3.20	164/02	10.90	3.00	175/01	17.50	3.30
076/01	3.40	2.70	312/04	5.80	22.90	184/11	7.90	7.90	163/01	10.96	2.80	233/01	17.80	3.00
090/02	3.50	3.00	141/01	5.84	5.72	125/08	8.00	1.80	165/03	11.00	3.00	261/01	17.80	5.80
140/08	3.50	7.90	100/01	6.00	1.50	135/05	8.00	2.80	168/01	11.00	3.30	286/02	17.90	8.20
090/01	3.66	2.80	105/04	6.00	2.00	135/08	8.00	3.00	178/03	11.00	4.30	235/04	18.00	3.00
105/03	3.70	4.30	110/03	6.00	2.50	140/13	8.00	3.50	167/02	11.20	3.00	408/01	18.00	20.30
108/14	3.70	4.00	113/05	6.00	2.80	137/01	8.10	3.10	185/05	11.20	4.80	290/09	18.46	8.00
093/01	3.80	3.00	116/01	6.00	3.10	164/04	8.10	5.80	184/08	11.60	4.30	210/10	18.50	0.00
085/08	4.00	2.00	140/06	6.00	5.40	191/03	8.10	8.50	172/01	11.70	3.00	240/02	18.50	3.00
095/02	4.00	3.00	108/09	6.10	2.16	135/04	8.13	2.79	176/02	11.80	3.30	249/01	18.90	3.50
095/01	4.20	2.80	109/04	6.10	2.30	138/01	8.16	3.10	177/07	11.85	3.35	245/01	19.00	3.00
105/05	4.20	3.60	147/06	6.10	6.10	135/10	8.20	2.80	177/01	12.00	3.20	405/01	20.00	18.00
108/13	4.20	4.10	118/02	6.26	3.00	140/12	8.20	3.30	178/01	12.30	3.00	260/05	20.50	3.00
108/10	4.30	4.00	108/03	6.30	2.00	138/02	8.30	3.00	184/10	12.30	3.60	266/03	21.10	3.00
097/01	4.50	2.70	113/04	6.30	2.54	140/07	8.30	3.15	271/01	12.30	12.30	345/01	24.00	8.00
100/07	4.50	3.00	113/06	6.50	2.30	135/02	8.50	2.50	177/02	12.40	2.80	300/01	24.20	3.30
108/07	4.50	3.80	120/05	6.50	3.00	140/03	8.50	3.00	186/01	12.40	3.80	335/01	25.00	6.00
118/04	4.50	4.80	109/05	6.60	1.80	195/03	8.50	8.50	180/06	12.46	3.00	313/01	26.00	2.80
125/05	4.80	5.11	118/01	6.60	2.70	140/14	8.70	2.80	218/02	12.50	6.80	316/03	26.06	3.00
085/03	5.00	1.00	123/01	6.60	3.20	143/02	8.80	3.00	184/02	12.60	3.00	320/01	26.46	3.00
100/04	5.00	2.50	125/10	6.60	3.40	147/09	8.90	3.30	185/01	12.70	3.30	355/01	30.00	2.90
105/01	5.00	3.00	121/01	6.70	2.90	115/03	9.00	0.00	203/01	12.70	5.11	340/05	34.00	4.00
108/12	5.00	3.30	125/04	6.70	3.30	140/02	9.00	2.54	184/06	12.80	3.10			
102/02	5.20	2.50	159/03	6.70	6.70	147/05	9.00	3.00	216/07	12.80	6.30			
108/04	5.30	3.00	122/01	6.71	3.00	180/07	9.00	6.50	184/01	12.90	3.00			
109/03	5.40	3.00	126/01	6.80	3.30	143/01	9.20	2.60	345/01	12.90	19.00			
117/01	5.40	3.80	138/03	6.80	4.50	142/01	9.30	2.40	185/04	13.00	3.00			
108/11	5.50	2.80	125/15	6.90	3.10	145/03	9.40	2.60	162/02	13.20	3.00			
116/02	5.50	3.30	110/02	7.00	1.50	140/04	9.50	2.00	209/02	13.30	5.11			
120/04	5.50	4.00	116/05	7.00	2.00	147/12	9.50	2.70	270/01	13.49	11.00			
108/02	5.70	2.54	125/01	7.00	3.00	137/04	9.60	1.60	185/08	13.70	2.30			
125/03	5.70	4.30	135/03	7.00	4.00	154/03	9.60	3.30	188/01	14.00	2.30			
135/01	5.70	5.30	147/02	7.00	5.11	155/01	9.80	3.15	195/01	14.00	3.00			
139/01	5.70	5.70												

E-tec 2015 © - all rights reserved



UNIT mm	GENERAL TOLERANCE		DRAWN Linda	DATE 24.06.2005	DWG. NO. SL1-Sxxx/xx/5	SHEET 2/2	
	X.° ±	X. ±					
	SCALE Free	.X° ±	.X ±	CHECK Kent	DATE 28.01.2016	SERIES NO. SL1-xxx-Sxxx/xx-xx/5	REV. C
		.XX° ±	.XX ± 0.25				
	.XXX° ±	.XXX ±	APPROVE SH	DATE 28.01.2016			

Pin Coed Sheet
5.08mm Pitch Pin Header
(2.54mm pitch insulator Void even pin)
-THT- Straight