

SD Series - D-Sub 90° US91 Ultra Slim Profile

"Wave Solder" (THT) & "Pin-In-Paste" (THR) Technology

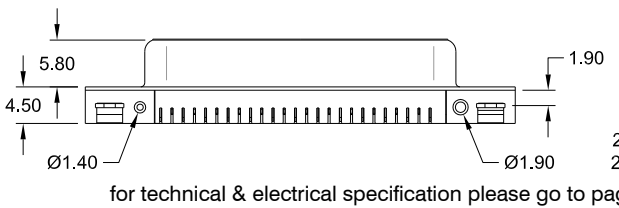

female

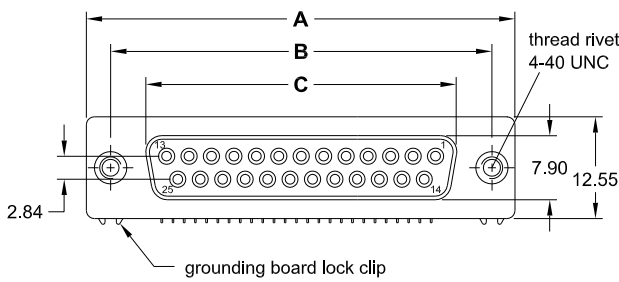

PCB hole layout

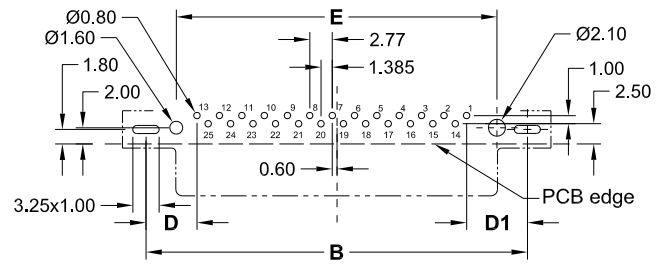

Special Product.
Please ask for availability and minimum order quantity before you consider the article for development, design in or production purposes.

No. of contacts	Dimension					
	A	B	C	D	D1	E
025	53.04	47.04	38.38	6.30	7.50	39.54
	2.088	1.852	1.511	.248	.295	1.557

Ordering Code

for "Wave Solder" (THT) Technology

SDF - 025 - US91F - 95 / N

for "Pin-In-Paste" (THR) Technology

SDF - 025 - US91F - 95 / SN

Option:

Jack Screw has to be ordered separately.

See page 70

Plating: -95= tin(leadfree)/gold

male

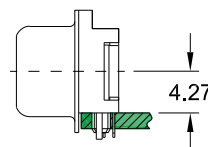
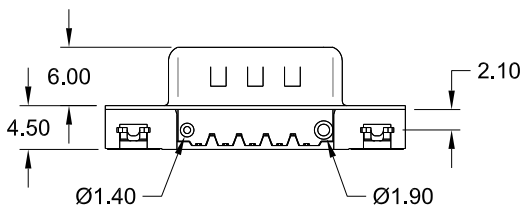
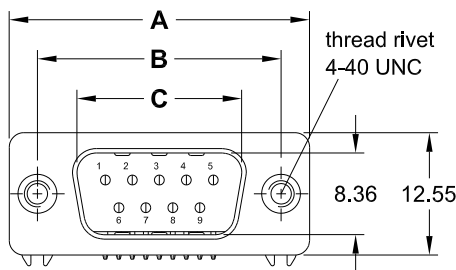

PCB hole layout

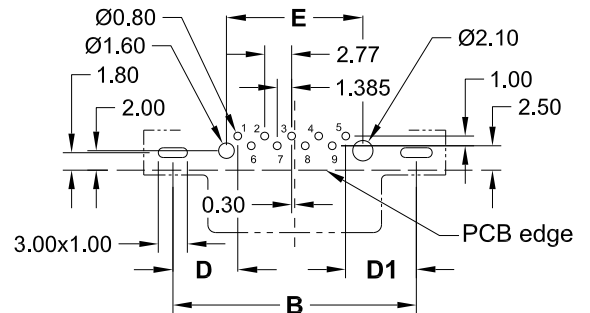

Special Product.
Please ask for availability and minimum order quantity before you consider the article for development, design in or production purposes.

No. of contacts	Dimension					
	A	B	C	D	D1	E
009	30.81	24.99	16.92	6.66	7.26	14.00
	1.213	.984	.666	..262	.286	.551

Ordering Code

for "Wave Solder" (THT) Technology

SDM - 009 - US91F - 95 / N

for "Pin-In-Paste" (THR) Technology

SDM - 009 - US91F - 95 / SN

Option:

Jack Screw has to be ordered separately.

See page 70

Plating: -95= tin(leadfree)/gold