

| Pin | "A" | "B" | "C" | Ordering code |
|-----|------------|---------------|---------------|------------------------|
| 8 | 10,16/.400 | 7,62 .300 | 10,16 .400 | QIT-308-W001-95 |
| 14 | 17,78/.700 | | | QIT-314-W001-95 |
| 16 | 20,32/.800 | | | QIT-316-W001-95 |
| 18 | 22,86/.900 | | | QIT-318-W001-95 |
| 20 | 25,40/1.00 | | | QIT-320-W001-95 |
| 24 | 30,48/1.20 | | | QIT-324-W001-95 |
| 28 | 35,56/1.40 | 15,24 .600 | 17,78 .700 | Not available |
| 24 | 30,48/1.20 | | | QIT-624-W001-95 |
| 28 | 35,56/1.40 | | | QIT-628-W001-95 |
| 32 | 40,64/1.60 | | | QIT-632-W001-95 |
| 40 | 50,80/2.00 | | | QIT-640-W001-95 |

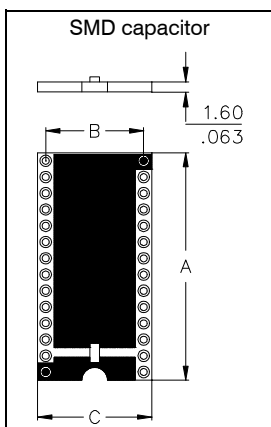

| Pin | "A" | "B" | "C" | Ordering code |
|-----|------------|---------------|---------------|------------------------|
| 8 | 10,16/.400 | 7,62 .300 | 10,16 .400 | QIT-308-S001-95 |
| 14 | 17,78/.700 | | | QIT-314-S001-95 |
| 16 | 20,32/.800 | | | QIT-316-S001-95 |
| 18 | 22,86/.900 | | | QIT-318-S001-95 |
| 20 | 25,40/1.00 | | | QIT-320-S001-95 |
| 24 | 30,48/1.20 | | | QIT-324-S001-95 |
| 28 | 35,56/1.40 | 15,24 .600 | 17,78 .700 | QIT-328-S001-95 |
| 24 | 30,48/1.20 | | | QIT-624-S001-95 |
| 28 | 35,56/1.40 | | | QIT-628-S001-95 |
| 32 | 40,64/1.60 | | | QIT-632-S001-95 |
| 40 | 50,80/2.00 | | | QIT-640-S001-95 |

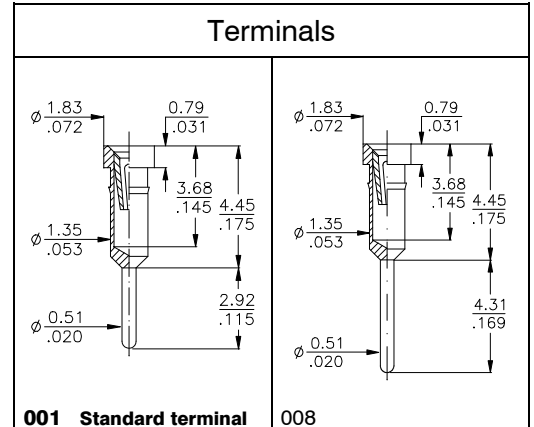
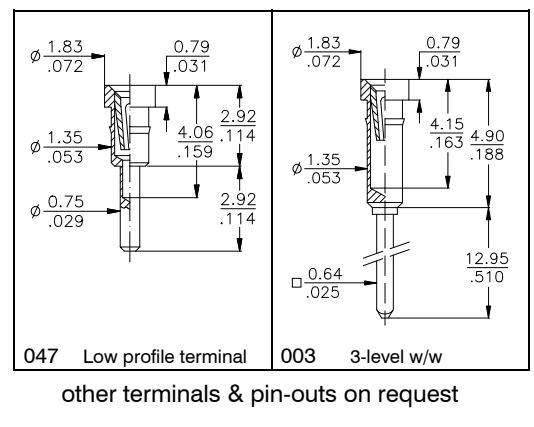

other terminals & pin-outs on request

| Socket Specifications | | | |
|--|---|---|---|
| Mechanical data | Insertion force Extraction force Contact life Solderability Contact security: -Vibration -Shock | 1,80 N (avg) 0,90 N (avg) > 100 cycles as per IEC 60068-2-58 as per EN60352-4 as per EN60352-4 | Electrical data Contact resistance at 1A Current rating Contact capacitance at 1MHz Insulation resistance at 500V DC Breakdown voltage at 60 Hz Contact resistance |
| Material | Insulator Terminal Contact | (RoHS compliant) (RoHS compliant) (RoHS compliant) | Hi temp plastic UL 94 V-0 (wired version) Epoxy FR4 if with SMD capacitor CuZn BeCu |
| Operating temperature | | | 4,3 mΩ typ. 1A max., 100V 2 pF max. 5 × 10 ⁹ Ω min. 500 V AC ≤ 7 mΩ -55° C to +125° C |
| Pitch | | | 2,54 mm (.100") |
| More information, for example about testresult please ref. to page 49 or contact E-tec. | | | |

| Capacitor Specifications | | | |
|--------------------------|-----------------------------|-------------|---|
| General data | Ceramic material Voltage | Z5U 50 V | Available capacitor values Standard type Alternatives: |
| | | | 100nF (0.1 μF) 10nF (0.01 μF) |

