

female - spring latch type -

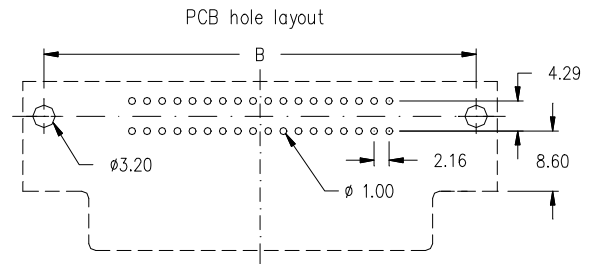

Option:

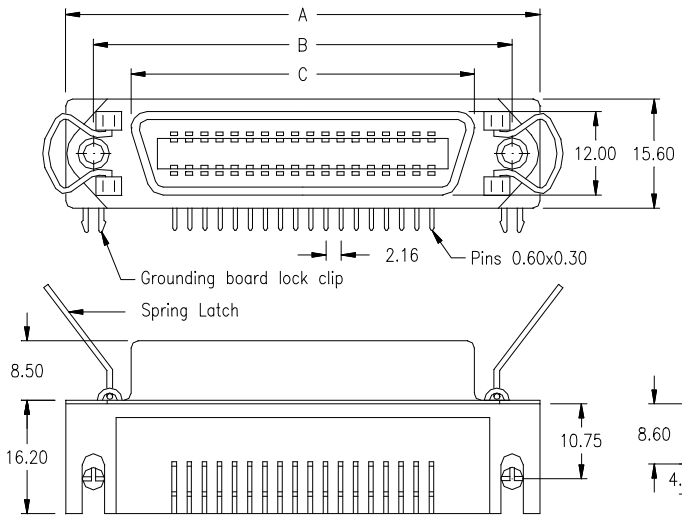
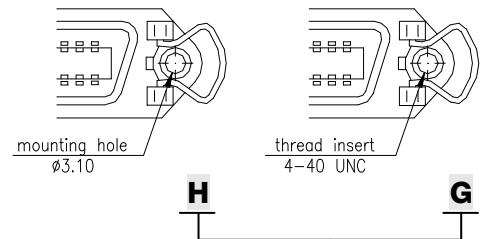

No. of contacts	Dimension		
	A	B	C
036	67.69	59.74	48.90
	2.665	2.352	1.925
050	82.78	74.85	64.00
	3.259	2.946	2.520

Ordering Code

CCF - xxx - S900 - 95 / N X

No. of contacts

Option

female - screw lock type -

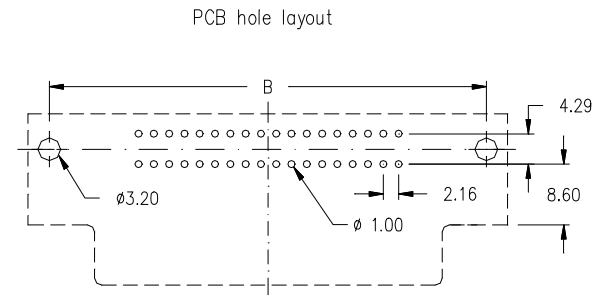
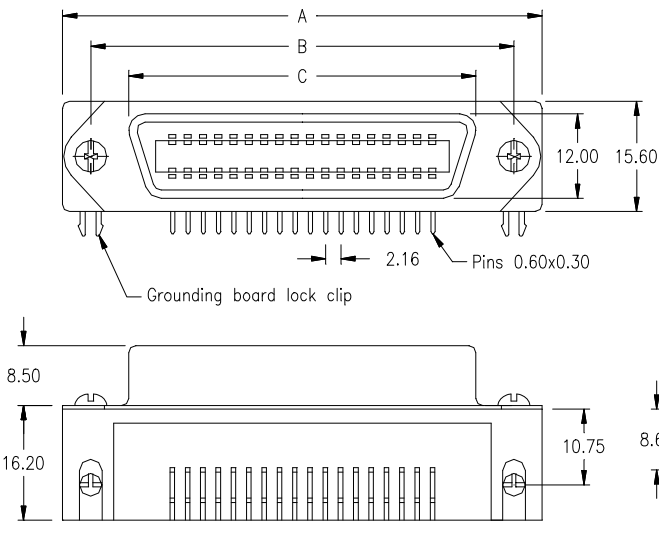

No. of contacts	Dimension		
	A	B	C
036	67.69	59.74	48.90
	2.665	2.352	1.925
050	82.78	74.85	64.00
	3.259	2.946	2.520

Ordering Code

CCF - xxx - S901 - 95 / NG

No. of contacts



mechanical data	
Mating force per contact	≤ 3,2 N
Unmating force per contact	≥ 0,7 N
Temperature range	-55° C to +105° C
Moisture absorption from air 50% rh	0,10%
IDC Connector types accept AWG 26 or AWG 28 standard wire	

materials and plating	
Insulator	thermoplastic glassfilled UL 94V - 0
Shell	steel
- plating	tin (leadfree)
Spring latch	stainless-steel
Male contact	phosphor bronze
- plating (tin leadfree)	-95 = solder side Sn; contact side Au over Ni -55 = solder and contact side Au over Ni
Female contact	phosphor bronze
- plating (tin leadfree)	-95 = solder side Sn; contact side Au over Ni -55 = solder and contact side Au over Ni

electrical data	
max. Current rating	5 A
Operating voltage	250 V
Test voltage between contacts	1000 V / 50/60 Hz / 1 min
Test voltage between shell and contacts	1000 V / 50/60 Hz / 1 min
Contact resistance	25 mΩ max. mated
Insulation resistance	1000 MΩ min. at 500V DC
Dielectric withstanding voltage	1000 V AC rms. for one Minute