

**female**

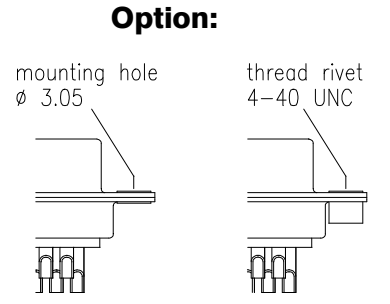

No. of contacts	Dimension		
	A	B	C
<b>015</b>	<u>30.81</u> 1.213	<u>24.99</u> .984	<u>16.33</u> .643
<b>026</b>	<u>39.14</u> 1.541	<u>33.32</u> 1.312	<u>24.66</u> .971
<b>044</b>	<u>53.04</u> 2.088	<u>47.04</u> 1.852	<u>38.38</u> 1.511
<b>062</b>	<u>69.32</u> 2.729	<u>63.50</u> 2.500	<u>54.84</u> 2.159

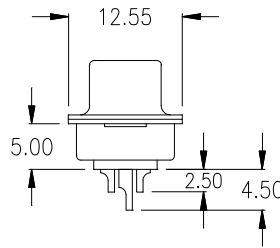
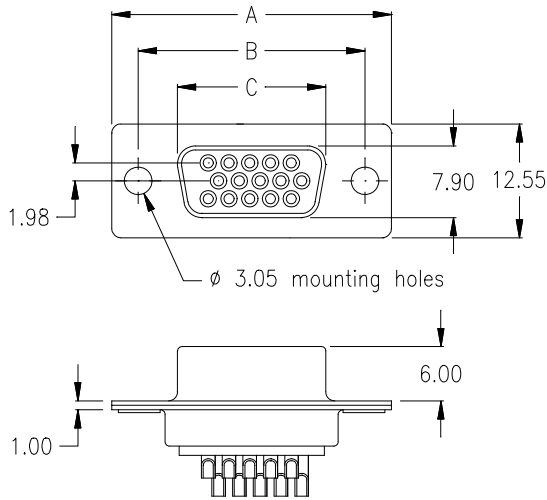
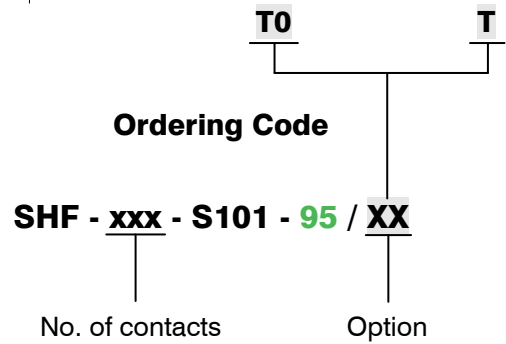

General Specification page 72

Plating: -95 = tin(leadfree)/gold

**male**

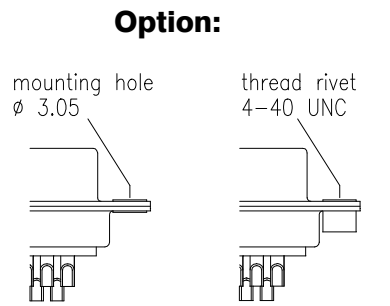
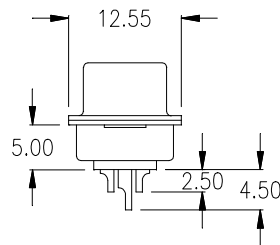
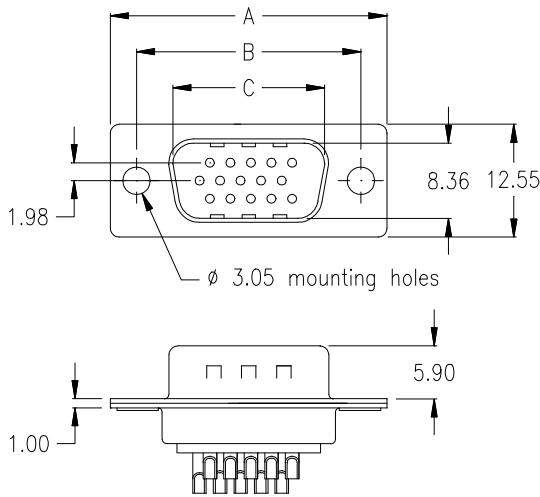

No. of contacts	Dimension		
	A	B	C
<b>015</b>	<u>30.81</u> 1.213	<u>24.99</u> .984	<u>16.92</u> .666
<b>026</b>	<u>39.14</u> 1.541	<u>33.32</u> 1.312	<u>25.25</u> .994
<b>044</b>	<u>53.04</u> 2.088	<u>47.04</u> 1.852	<u>38.96</u> 1.534
<b>062</b>	<u>69.32</u> 2.729	<u>63.50</u> 2.500	<u>55.42</u> 2.182

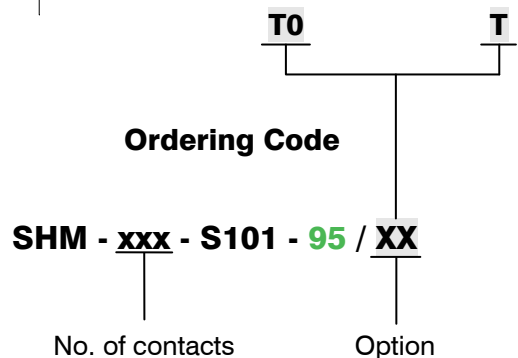

General Specification page 72

Plating: -95 = tin(leadfree)/gold



**mechanical data**

Mating force per contact	≤ 3,4 N
Unmating force per contact	≥ 0,2 N
Temperature range	-55° C to +105° C
Processing temperature wave solder (solder bath)	+250°C +0/-5°C for 10sec.
Processing temperature SMT and “pin in paste”	+250°C +0/-5°C for 10sec.
Moisture absorption from air 50% rh	0,10%
IDC Connector types accept AWG 26 or AWG 28 standard wire	

**materials and plating** (RoHS compliant)

Insulator for wave solder technology, standard black - PC 99 colourful insulator	thermoplastic glassfilled UL 94V – 0 Yellowish brown - Pantone # 131C 15-pos. female Burgundy - Pantone # 235C 25-pos. female Teal - Pantone # 322C 9-pos. male Blue - Pantone # 661C HD 15-pos.
female	
Insulator for SMT and “Pin-In-Paste”	Nylon UL 94V-0
Shell	Steel, Ni plated
Bracket	Brass, tin plated
Male contact	Copper Alloy (Standard; others on request)
- plating	-95 = solder side Sn; contact side Au over Ni -55 = solder and contact side Au over Ni
Female contact	Copper Alloy (Standard; others on request)
- plating	-95 = solder side Sn; contact side Au over Ni -55 = solder and contact side Au over Ni -NN = Ni
D-Sub Accessories (page 70) plating	

**electrical data**

max. Current rating	5 A/25°C 3 A/70°C (High Density types 3A / IDC types 1A)
Operating voltage	250 V
Test voltage between contacts	1000 V / 50/60 Hz / 1 Minute
Test voltage between shell and contacts	1000 V / 50/60 Hz / 1 Minute
Resistance between mated contacts	< 30 m Ω
Insulation resistance	≥ 1000 M Ω at 500V DC
Dielectric strength	1000 V AC min. for 1 Minute
Volume resistivity	10 <sup>16</sup> Ω cm (ASTM-D 257 )

**available performance classes**

E-tec D-Sub connectors comply with Performance Class 3 (min. 50 contact cycles).  
Please contact E-tec first for availability of Performance Class 2 (min. 200 contact cycles) and 1 (min. 500 contact cycles)

**D-Sub with Filter ( ferrite )**

Frequency range	10 - 300 MHz
Impedance	5 MHz - 15 Ω
	25 MHz - 30 Ω
	100 MHz - 50 Ω
	300 MHz - 75 Ω

