

1.00mm pitch Pin Header  
 - SMT - low profile dual row

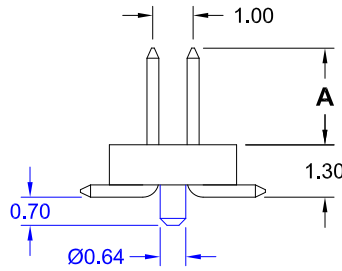
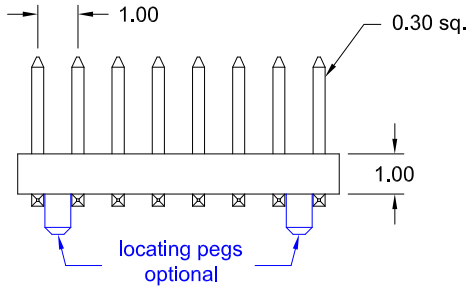
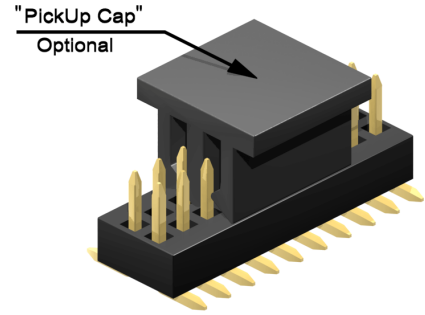
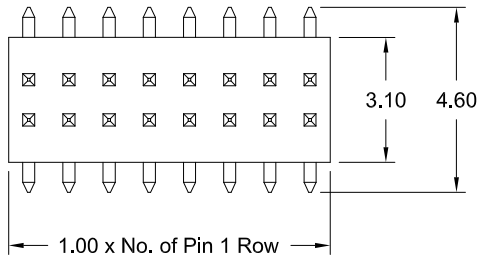

**Application and Features**

- **Standard: Tube packing, without "locating pegs" and without "PickUp Cap"**
- Assures reliable PC Board connections
- Fine pitch, low profile type with 0.30mm square pin
- Mate with Female Header BS2-xxx-H222-55/00X then "board to board" distance 3.60mm

**PCB Surface Mount Layout**

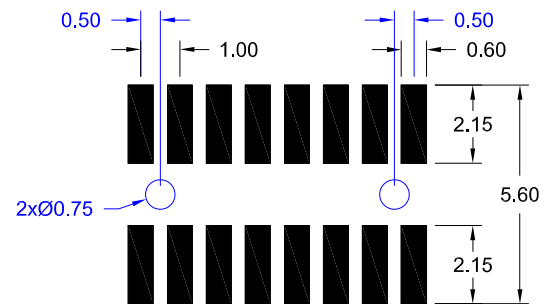

**Specifications**

Current rating	1 A
Insulation resistance	1000 MΩ min.
Withstanding voltage	500 V AC

Operating temperature	- 40°C to +105°C
Processing temperature	+250°C +0/-5°C for 5sec.
Contact material	(RoHS compliant) Copper Alloy
Insulator material	(RoHS compliant) PA9T UL 94 V-0

**How to order**

SS2 - xxx - H 18/x - 55/00 X

Nbr of pins	Pin code	DIM "A"	Plating	Options
008 to 100	18/0	1.90 mm	55 = Gold	<b>without "locating pegs"</b>
	18/1	2.40 mm		A = Tube packing; with „PickUp Cap“
	18/2	1.65 mm		B = Reel packing; with „PickUp Cap“
	18/3	5.40 mm		<b>with "locating pegs"</b>
	18/4	3.00 mm	other platings on request	C = Tube packing; without „PickUp Cap“
				D = Tube packing; with „PickUp Cap“
				E = Reel packing; with „PickUp Cap“