

1.27mm - SMT - Pin Header  
 dual row 1.27mm x 2.54mm

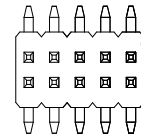
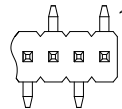
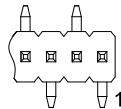
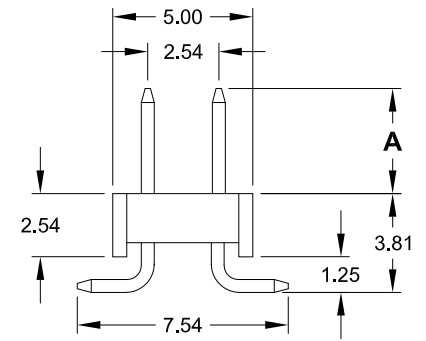
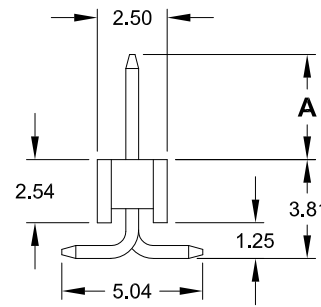
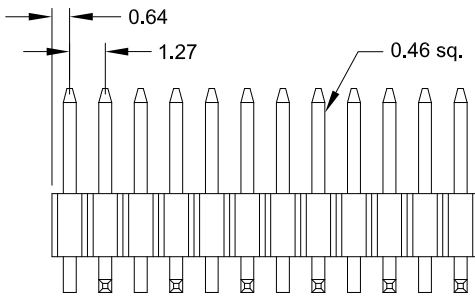
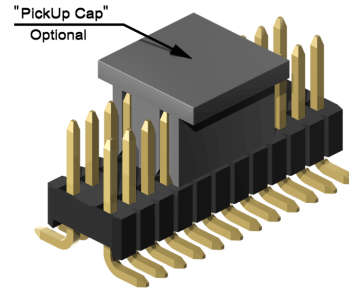
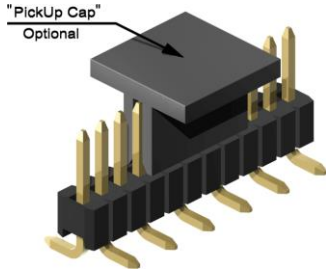

Foot Style:

**380**

**381**

**380**

**Specification**

Current rating	1 A
Insulation resistance	1000 MΩ min.
Withstanding voltage	500 V AC
Operating temperature	- 40°C to +105°C
Processing temperature	+250°C +0/-5°C for 5sec.
Contact material	(RoHS compliant) Copper Alloy
Insulator material	(RoHS compliant) PA6T UL 94 V-0

**PCB Surface Mount Layout**

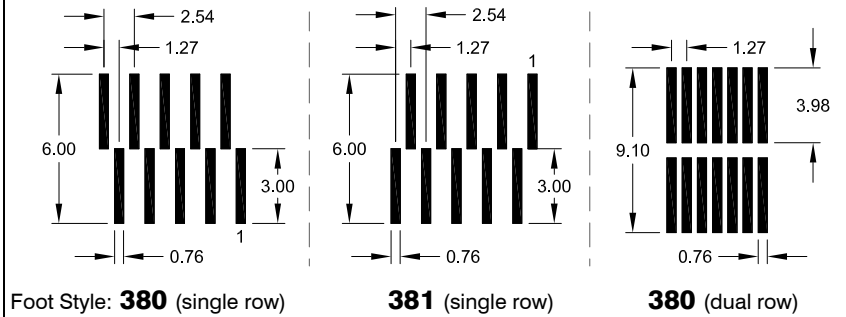

**How to order**

SS x - xxx - H xxx / x - 55/1 X

Rows	Nbr of pins	Foot Style	Pin code	DIM "A"	Plating	Packing and "PickUp Cap" Option
1 = single row	003 to 050	380	/ 0	2.80 mm	55 = Gold	A = Tube packing; with "PickUp Cap" B = Reel packing; with "PickUp Cap"
		381	/ 0	2.80 mm		
2 = dual row	006 to 100	380	/ 0	2.80 mm	other platings on request	
		380	/ 1	4.50 mm		
		380	/ 2	5.50 mm		
		380	/ 3	4.80 mm		
				other dimensions on request		